

Flat 27, Lifestyle House, Melbourne Avenue, Sheffield, S10 2QH



# Flat 27, Lifestyle House, Sheffield, S10 2QH

## Description

A quite superb, two bedroom, first floor apartment boasting an immaculate finish throughout, perfect for those looking for somewhere ready to move into that they don't need to renovate. Lifestyle House is a highly regarded development of independent living quarters for the 55+ age group, supported by an onsite manager and careline that combine to provide cover 24 hours a day. The location is ideal, a short walk away from the excellent amenities found in the Broomhill area including numerous restaurants and transport links into town and close to the Botanical Gardens which provides an oasis of calm in this otherwise thriving and busy area. The development includes off road parking and the use of a residents lounge where various activities are arranged and enjoyed.

- For Sale by Modern Auction - T&C's apply
- Double bedroom with fitted wardrobes.
- Versatile second bedroom/study.
- Modern fitted kitchen with integrated fridge and freezer.
- Luxurious shower room with contemporary fixtures and fittings.
- Communal off road parking.
- Communal gardens for residents to enjoy.
- UPVC double glazing and electric storage heating.
- Independent living with the benefits of an onsite warden.
- No onward chain. Tax band A /EPC 60:D/ Lease 1996-2196









48 sq m/516.66 sq ft  
Approx.

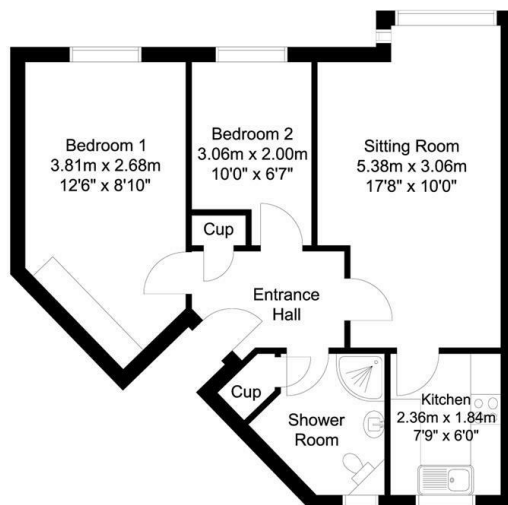

Whilst every attempt has been made to ensure the accuracy of the floor plan contained here, no responsibility is taken for incorrect measurements of doors, windows, appliances and rooms or any error, omission or misstatement. Exterior and interior walls are drawn to scale based on interior measurements. Any figure given is for initial guidance only and should not be relied on as a basis of valuation. The plans are for marketing purposes only and should only be used as such.  
No guarantee is given on the accuracy of the total square footage/ meterage if quoted on this plan.  
CP Property Services @2022

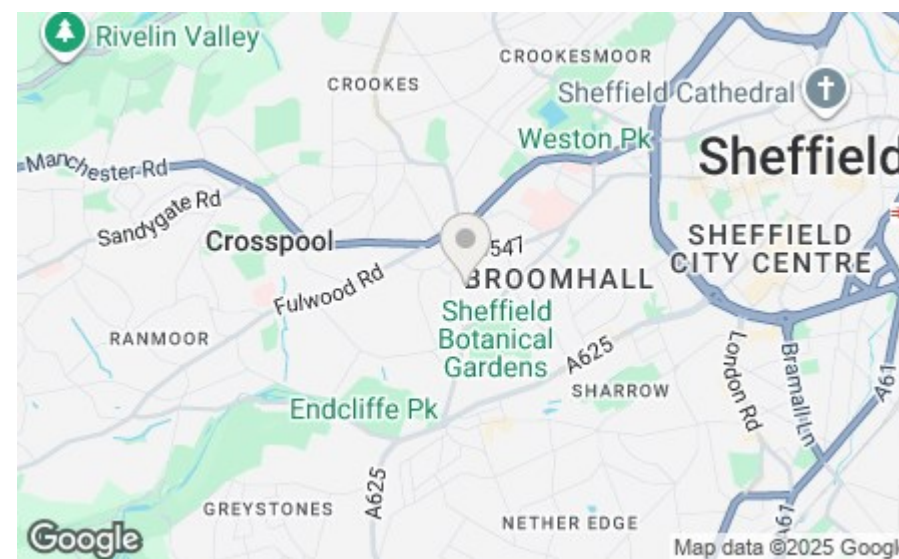

**Bakewell**  
3 Royal Oak Place  
Matlock Street  
Bakewell DE45 1HD  
T: 01629 700699  
E: bakewell@elr.co.uk

**Banner Cross**  
888 Ecclesall Road  
Banner Cross  
Sheffield S11 8TP  
T: 01142 683388  
E: bannercross@elr.co.uk

**Dore**  
33 Townhead Road  
Sheffield  
S17 3GD  
T: 0114 2362420  
E: dore@elr.co.uk

**Hathersage**  
Main Road, Hathersage  
Hope Valley  
Derbyshire S32 1BB  
T: 01433 651888  
E: peakdistrict@elr.co.uk

**Rotherham**  
149 Bawtry Road  
Wickersley  
Rotherham S66 2BW  
T: 01709 917676  
E: wickersley@elr.co.uk

**EADON  
LOCKWOOD  
& RIDDLE**  
ESTD 1840

All rooms have been measured with electronic laser and are approximate measurements only. None of the services to the above property have been tested by ourselves, and we cannot guarantee that the installations described in the details are in perfect working order. Eadon Lockwood & Riddle for themselves, and for the vendors or lessors, produce these brochures in good faith, and are a guideline only. They do not constitute any part of a contract and are correct to the best of our knowledge at the time of going to press.